

REV	DATE	DESCRIPTION	APP.
NEW	3/13/13	NEW DRAWING	ERL
A	8/16/13	CHANGED 90MM DIM TO 110MM ACCORDING TO MODEL CHANGE	GD

BAR CROSS-SECTIONS:

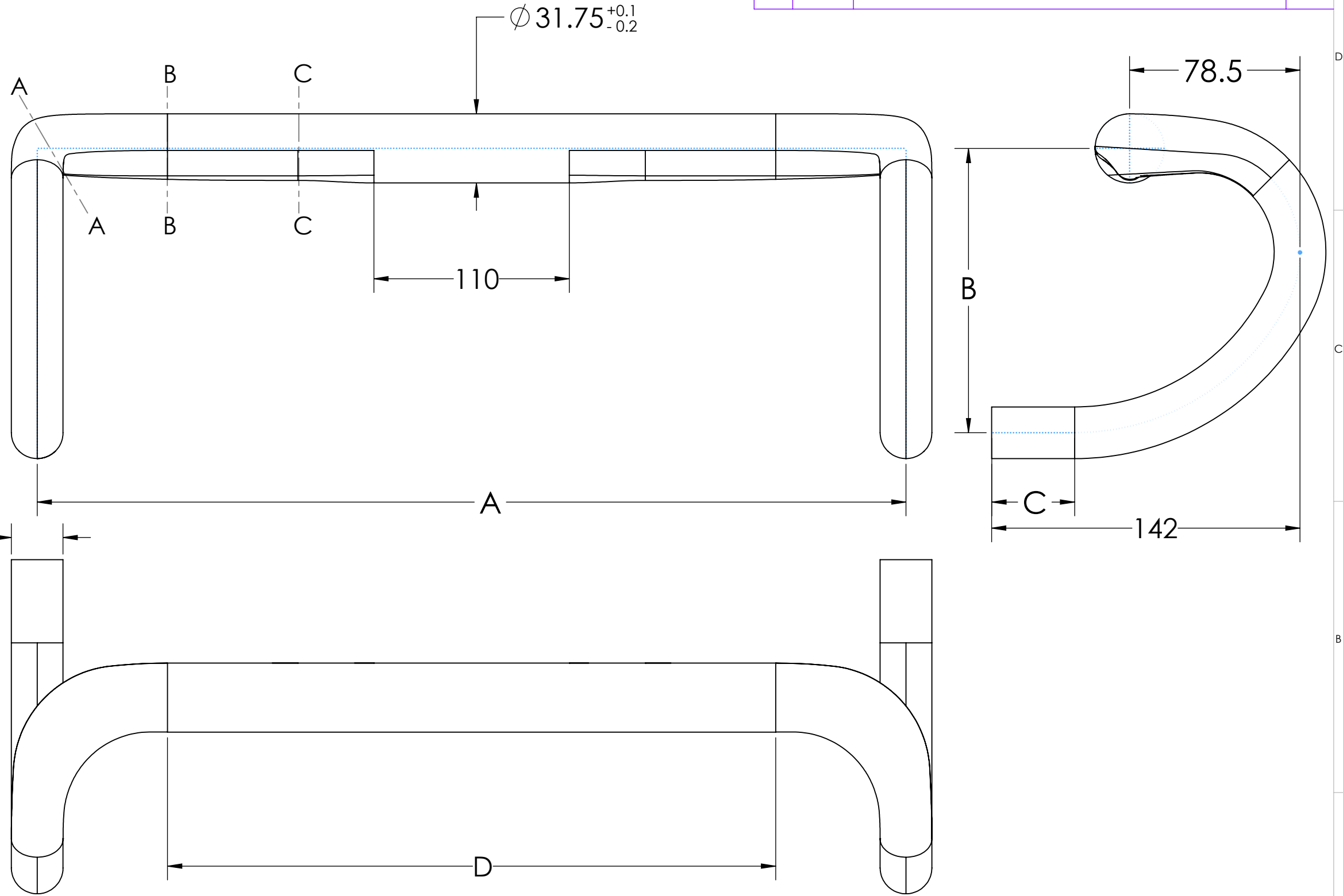
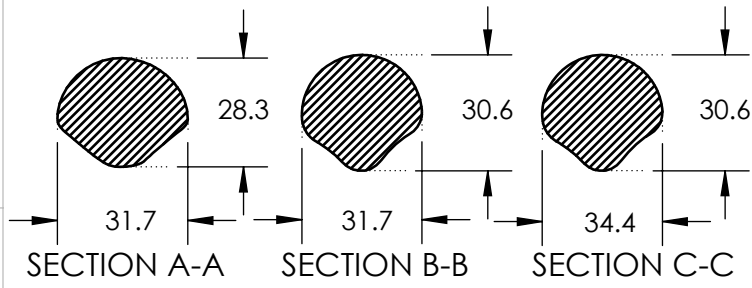

$\phi 23.8 \pm .2$

MODEL NUMBER	WEIGHT (g)	"A" (mm)	"B" (mm)	"C" (mm)	"D" (mm)
HB-E110	202	400	131	38	280
HB-E111	204	420	133	37	300
HB-E112	206	440	135	36	320

USED ON:	DRAWN: ELASSIER	DATE: 3/1/2013	L.H. THOMSON COMPANY CORPORATE OFFICES MACON, GA 31216
CHECKED: G DENES	DATE: 8/16/13		
SECTION NO.	QA:	DATE:	THOMSON CARBON CROSS BAR- SIZE DIAGRAM
CHANGE NO.			
			SIZE: B CAGE CODE: DRAWING NO. WEB 010

FILE: I:\BIKE THOMSON\117\117101-4_7_10_12 (CARBON ROAD AND CROSS BARS) SHEET 2 OF 2